

# Strategic Site 13

## Illustrative concept masterplan

### Land at Moortown Lane, Ringwood

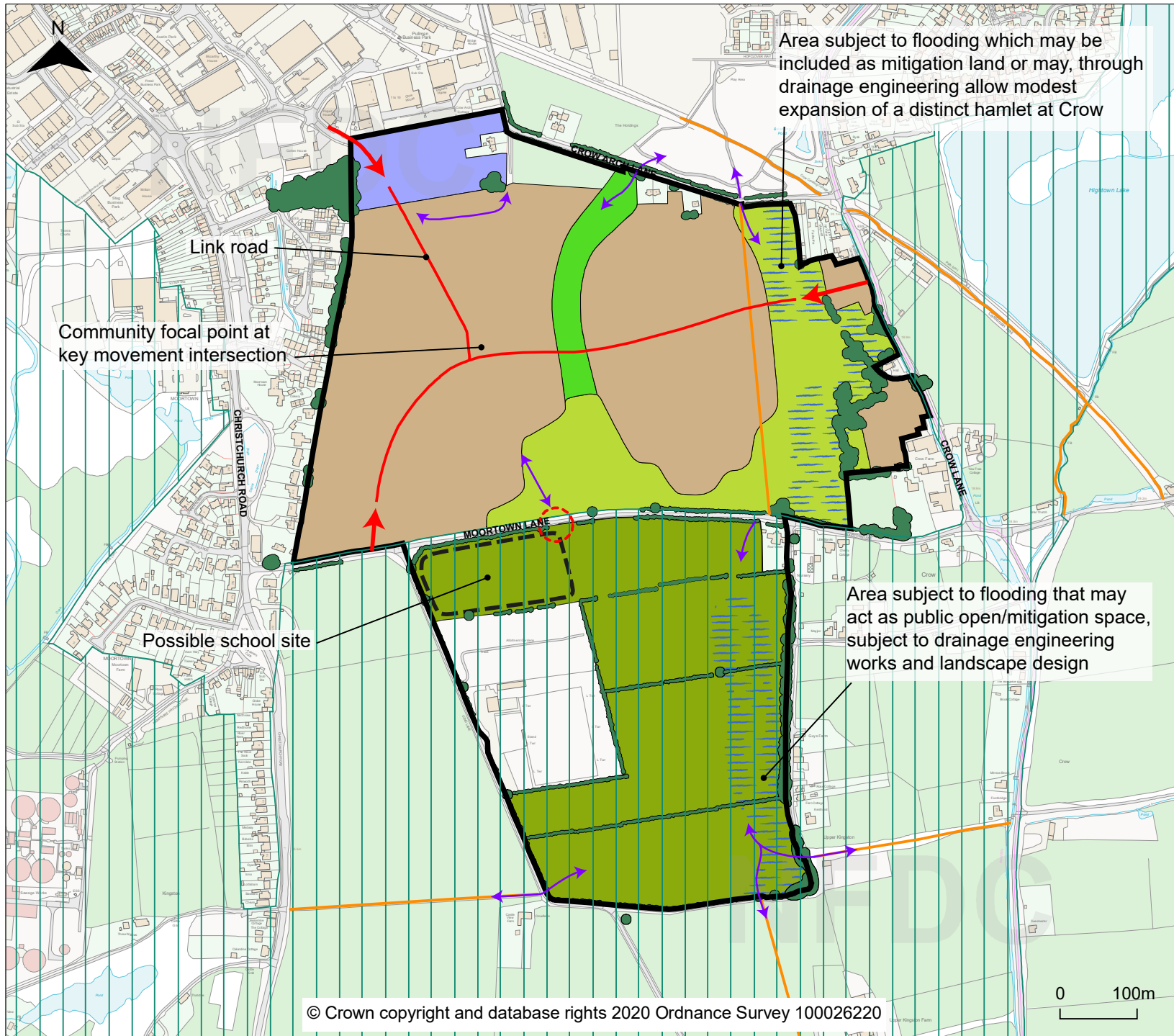

Area subject to flooding which may be included as mitigation land or may, through drainage engineering allow modest expansion of a distinct hamlet at Crow

Area subject to flooding that may act as public open/mitigation space, subject to drainage engineering works and landscape design

Link road  
Community focal point at key movement intersection

Possible school site

- Public open space suitable for mitigation (ANRG)
- Potential public open space
- Existing and potential open space
- Residential
- Employment
- Retained Green Belt
- Area susceptible to flood
- Vegetation of landscape value
- Indicative primary access
- Non-vehicular access
- Public right of way (PROW)
- Potential crossing